

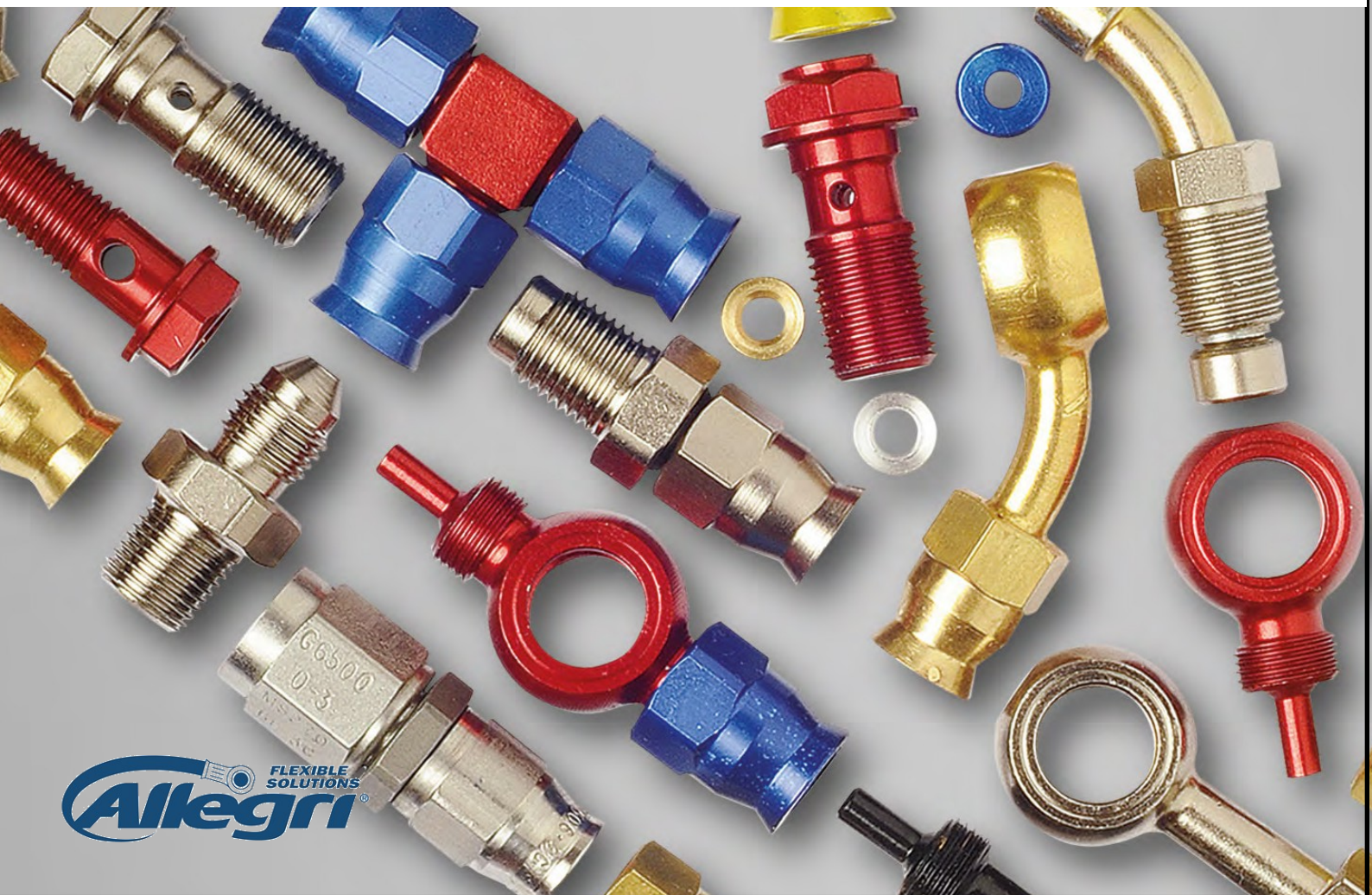

HOSE & FITTINGS 2026



GLOBAL SYSTEM

B&H Global System brake hoses are designed to be as adaptable as possible, making it easy and affordable to fit out almost any bike with high quality brake lines.

The back bone of the system is a stainless steel braided hose with a protective sheath and female threaded sockets permanently crimped onto each end. To complete the system, there is a wide range of banjos and fittings that screw directly onto the hoses. Simply work out the fittings you need at each end, and select the length of hose you need to create a complete brake line for your bike.

Available in either silver or black, the look will compliment any bike and the performance is second to none.

This system is 100% compliant with New Zealand Land Transport W.O.F. regulations.

Note: standard fittings can be used with the Global System hose by removing the nut and olive - this will meet W.O.F requirements

STANDARD HOSE AND FITTINGS

B&H brake hoses and fittings are made to the strictest quality specifications by Italy's premier automotive hose and fitting manufacturer.

A P.T.F.E. hose core is reinforced with AISI 304 Stainless steel braid and covered with a clear PVC protective sheath. A nut and olive fitting system is used to attach a wide range of high quality end fittings to the hose, meaning almost any imaginable hose configuration can be built up quickly and safely. Simply work out the fittings you need at each end and specify the length of hose you need to create a complete brake line for your bike. With fittings available in either plated bronze or anodised aluminium, the look will compliment any bike and the performance is second to none.

Note: This system is intended for off-road and race use only. It is not compliant with New Zealand Land Transport regulations for Warrant Of Fitness. For W.O.F. compliant brake hoses, please use the B&H Global System range.

GLOBAL SYSTEM

GLOBAL SYSTEM HOSE

Silver	Black
BH GS__TWM	BH GS__NWM

BH 3694 Rubber seal for hose



BANJO - Straight

Ø	Silver	Black	Alu
6			BH 5708 red
10.1	BH GSF326	BH GSF5393	
11.1	BH GSF264	BH GSF5394	
12.1		BH GSF5395	



BANJO - 15°

Ø	Silver
10.1	BH GSF8511



BANJO - 25°

Ø	Silver	Black
10.1	BH GSF350	BH GSF5396



BANJO - 35°

Ø	Silver	Black
10.1	BH GSF8099	



BANJO - 45°

Ø	Silver	Black
10.1	BH GSF314	BH GSF5397
11.1		BH GSF5398



BANJO - 60°

Ø	Silver	Black
10.1	BH GSF339	BH GSF5399



BANJO - 90°

Ø	Silver	Black
10.1	BH GSF325	BH GSF5400
11.1		BH GSF5401



BANJO SIDE BEND - 15°

Ø	Silver
10.1	BH GSF8512



BANJO SIDE BEND - 25°

Ø	Silver	Black
10.1	BH GSF773	BH GSF5404



BANJO SIDE BEND - 90°

Ø	Silver
10.1	BH GSF3780



BANJO SIDE BEND LONG - 90°

Ø	Silver
10.1	BH GSF6482



BANJO - Short

Ø	Silver	Black	Alu
6			BH 5914 red
10.1	BH GSF128	BH GSF5402	



BANJO - Twin Outlet

Ø	Silver
10.1	BH GSF78



TEE FITTING

Steel	Alu	Black
BH GSF4300	BH GSF692	BH GSF5432



HOSE TO HOSE JOINER

Silver
BH GSF3725



3 WAY JUNCTION WITH 6 mm BOLT HOLE

Silver
BH GSF6705



FIXED STRAIGHT MALE

Ø	Alu (red)
6 x 1	BH 6274
8 x 0.75	BH 5791
8 x 1	BH 6275

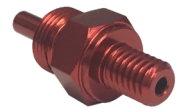

BULKHEAD FIXED CONCAVE SEAT MALE

Ø	Silver
3/8" x 24 unf	BH GSF3719
10 x 1	BH GSF3718
10 x 1.25	BH GSF3720



FIXED CONCAVE SEAT MALE

Ø	Silver	Black
10 x 1	BH GSF3714	BH GSF5409
10 x 1.25	BH GSF3715	BH GSF5410
3/8" x 24 unf	BH GSF3721	BH GSF5411



FIXED CONCAVE SEAT FEMALE

Ø	Silver
10 x 1	BH GSF3713
10 x 1.25	BH GSF3716



FIXED CONCAVE SEAT FEMALE (clip fixing)

Ø	Silver
10 x 1	BH GSF333
10 x 1.25	BH GSF3717
3/8" x 24 unf	BH GSF3712



SWIVEL MALE - Straight

Ø	Silver	Black
10 x 1	BH GSF3700	BH GSF5412
10 x 1.25	BH GSF3701	BH GSF5413



SWIVEL MALE - 45°

Ø	Silver	Black
10 x 1	BH GSF3702	BH GSF5414
10 x 1.25	BH GSF3703	BH GSF5415



SWIVEL MALE - 90°

Ø	Silver	Black
10 x 1	BH GSF3704	BH GSF5416
10 x 1.25	BH GSF3705	BH GSF5417



SWIVEL FEMALE - Straight

Ø	Silver	Black
3/8" x 24 unf	BH GSF3707	BH GSF5426



SWIVEL FEMALE - 45°

Ø	Silver	Black
3/8" x 24 unf	BH GSF3709	BH GSF5427



SWIVEL FEMALE - 90°

Ø	Silver	Black
3/8" x 24 unf	BH GSF3711	BH GSF5428



STANDARD HOSE AND FITTINGS

HOSE

Silver	
BH 2173	1/8" brake hose with 304 stainless steel wire braid and transparent sheathing

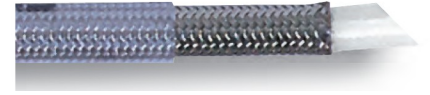

BANJO - Straight

Ø	Silver	Alu
8.1	BH 4484	
10.1	BH 317	BH 297 blue
11.1	BH 312	
12.1	BH 4455	



BANJO - 25°

Ø	Silver	Alu
10.1	BH 352	BH 436 blue



BANJO - 45°

Ø	Silver	Alu
10.1	BH 368	BH 485 blue
11.1	BH 4055	



BANJO - 60°

Ø	Silver	Alu
10.1	BH 369	BH 519 blue



BANJO - 90°

Ø	Silver	Alu
10.1	BH 417	BH 437 blue
11.1	BH 4056	



BANJO SIDE BEND- 25°

Ø	Silver	Alu
10.1	BH 794	BH 517 blue



BANJO - Short

Ø	Silver	Alu
10.1	BH 1203	BH 1216 blue
12.1	BH 4433	



BANJO - Twin Outlet

Ø	Silver	Alu
10.1	BH 1204	BH 1217 blue



BULKHEAD FIXED CONCAVE SEAT MALE

Ø	Silver
10x1	BH 4057
10x1.25	BH 4058
3/8" x 24 unf	BH 4059



FIXED CONCAVE SEAT MALE

Ø	Silver
10x1	BH 1472
10x1.25	BH 1473
3/8" x 24 unf	BH 3971



FIXED CONCAVE SEAT FEMALE (clip fixing)

Ø	Silver
10 x 1	BH 343
10 x 1.25	BH 4061
3/8" x 24 unf	BH 410



FIXED CONCAVE SEAT FEMALE

Ø	Silver
10 x 1	BH 1454
10 x 1.25	BH 4060



FIXED CONVEX SEAT FEMALE

Ø	Silver
10 x 1	BH 4314
10 x 1.25	BH 4316



FIXED CONVEX SEAT FEMALE (clip fixing) - 90°

Ø	Silver
10 x 1	BH 4064



SWIVEL MALE - STRAIGHT

Ø	Silver	Alu
10 x 1	BH 1200	BH 1313 blue
10 x 1.25	BH 1196	BH 1316 blue



SWIVEL MALE - 45°

Ø	Silver	Alu
10 x 1	BH 1201	BH 1314 blue
10 x 1.25	BH 1197	BH 1317 blue



SWIVEL MALE - 90°

Ø	Silver	Alu
10 x 1	BH 1202	BH 1315 blue
10 x 1.25	BH 1198	BH 1318 blue



SWIVEL FEMALE - STRAIGHT

Ø	Silver	Alu
1/8" gas	BH 318	
3/8" x 24 unf	BH 1370	BH 1330 blue



SWIVEL FEMALE - 45°

Ø	Silver	Alu
1/8" gas	BH 319	
3/8" x 24 unf	BH 1371	BH 1331 blue



SWIVEL FEMALE - 90°

Ø	Silver	Alu
1/8" gas	BH 320	
3/8" x 24 unf	BH 1372	BH 1332 blue



BULKHEAD MALE

Ø	Silver
3/8" x 24 unf	BH 302



NUT FOR BULKHEAD

Ø	Silver
3/8" x 24 unf	BH 307



FEMALE - FEMALE ADAPTOR

Ø	Silver
10 x 1	BH 1474



MALE - MALE ADAPTOR

Ø	Silver	Alu
3/8" x 24 unf - 1/8" gas	BH 605	
7/16" x 20 unf - 1/8" NPT		BH 699 blue



MALE - MALE ADAPTOR

Ø	Silver
10 x 1 - 1/8" gas	BH 470
10 x 1.25 - 1/8" gas	BH 467



MALE-MALE ADAPTOR

Ø	Silver
3/8" x 24 unf - 1/8" NPT	BH 5720



MALE - FEMALE ADAPTOR

Ø	Silver
3/8" x 24 unf - 10 x 1	BH 641



MALE - FEMALE ADAPTOR

Ø	Silver
1/8" gas - 10 x 1	BH 634
1/8" gas - 10 x 1.25	BH 637
1/8" gas - 3/8" x 24 unf	BH 616
12 x 1 - 10 x 1	BH 1488



BANJO ADAPTOR FEMALE - Straight

Ø	Silver
10 x 1	BH 359



BANJO ADAPTOR FEMALE - 25°

Ø	Silver
10 x 1	BH 516



BANJO MALE ADAPTOR

Ø	Silver
10.1-3/8" x 24 unf	BH 951



TO MALE FOR RUBBER HOSE

Ø	Alu
7/16 x 20	BH 194 blue



NIPPLE - Male

Ø	Alu
3/8" x 24 unf	BH 706 blue

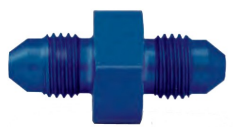

NIPPLE - Male

Ø	Silver
1/8" gas	BH 660



TEE - Male

Ø	Alu
3/8" x 24 unf	BH 695 blue



TEE - Harley Davidson

Silver	Black
BH 5285	BH 5433



3-WAY CONNECTOR

Silver	Alu
BH 4301	BH 1199 blue



90° ELBOW

Alu
BH 1174 blue



NUT

Silver	Alu
BH 281	BH 282 gold



OLIVE

Silver
BH 288



BANJO BOLT - Single

Ø	Silver	Alu	Black
8	BH 426		
10 x 1	BH 427	BH 441 gold	BH 5522
10 x 1.25	BH 413	BH 462 gold	BH 5523
12 x 1	BH 4041		
3/8" x 24 unf	BH 414	BH 471 gold	BH 5524
1/8" gas	BH 425		
7/16" x 24 unf	BH 1348		



BANJO BOLT WITH STOP SWITCH - Single

Ø	Silver
10 x 1	BH 4501C
10 x 1.25	BH 4502C
3/8" x 24 unf	BH 5269C
7/16" x 24 unf	BH 5280C



BANJO BOLT - Double

Ø	Silver	Alu	Black
10 x 1	BH 435	BH 443 gold	BH 5526
10 x 1.25	BH 335	BH 496 gold	BH 5527
3/8" x 24 unf	BH 379	BH 327 gold	BH 5528



BANJO BOLT WITH STOP SWITCH - Double

Ø	Silver
10 x 1	BH 4503C
10 x 1.25	BH 4504C



MILLED BANJO BOLT - Single

Ø	Silver	Alu
6 x 1	BH 5014	
8 x 1		BH 4128 red
10 x 1	BH 7533	BH 4019 red
10 x 1.25	BH 2393	BH 4020 red



MILLED BANJO BOLT - Double

Ø	Silver
10 x 1	BH 2362
10 x 1.25	BH 2363



MILLED BANJO BOLT FOR BLEED - Single

Ø	Silver	Alu
6 x 1	BH 5019	
10 x 1	BH 2373C	BH 2371C gold
10 x 1.25	BH 2392C	BH 2914C gold



MILLED BANJO BOLT FOR BLEED - Double

Ø	Silver	Alu
10 x 1	BH 2364C	BH 2368C gold
10 x 1.25	BH 2365C	BH 2369C gold



ACCESSORIES

RESERVOIR FLUID HOSE

∅	
7 x 12	BH 2120
6.5 x 10.5	BH 6505



FLUID HOSE CLIP

∅	
7 x 12	BH 2519
6.5 x 10.5	BH 4285



CONVEX / CONCAVE ADAPTOR

BH 65



WASHER

∅	Alu	Copper
11 x 15 x 1.5	BH 419	
10.2 x 14 x 1.5	BH 420	
10.2 x 13.9 x 1		BH 4400

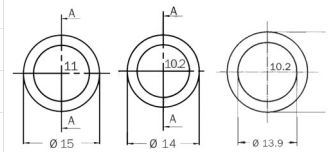

BLEED NIPPLE

∅	
6 x 1	BH 2360C
10 x 1	BH 4729C



BLEED NIPPLE CAP

Plastic	BH 3697
Rubber	BH 4267

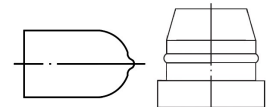

BH 3697

BH 4267

OIL TEMP SENSOR

∅	
10 x 1	BH 4339



VALVE CAP

Alu
BH 2470



RIGID BLACK SHEATHING

BH 1959



TRANSPARENT HEAT SHRINKABLE TUBING

BH 1960



SEMI-RIGID WHITE SHEATHING

BH 1961



SPIRAL PVC HOSE COVER

BH 1936



HEAT SHRINK SLEEVE

BH 6692



BH 6054



SLEEVES

86 mm BH 98



39 x 12 BH 109

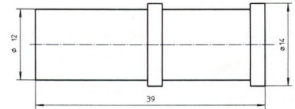

COVERS

48 mm BH 83

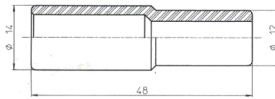

54 mm BH 100

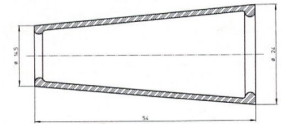

74.5 mm BH 2970

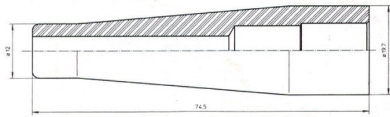

42 mm BH 102



Banjo cover
BH B21030



GROMMETS

20 x 10 BH 161

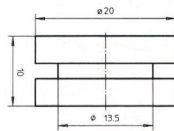

24.5 x 14.1 BH 182

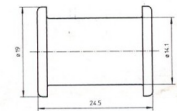

21 mm BH 206

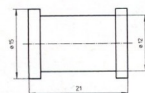

RUBBER

9 X 20 BH 74

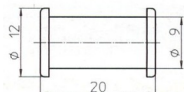

BUSH

8 X 15 BH 97

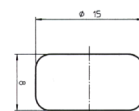

CABLE GUIDE

6 mm	BH 2514
Rubber for 2514	BH 6146

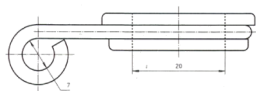

BH 4450

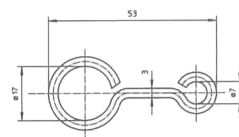

HOSE CLAMP

BH 85

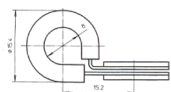

BANJO PLUG

BH 4018



EPDM O RING 6 x 1

BH 4826





Email: sales@eurobike.co.nz | Phone: 06-7586798